

500' DRAINAGE MAP

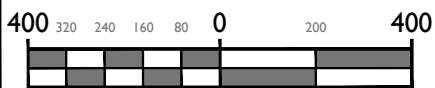

SCALE : 1" = 400'

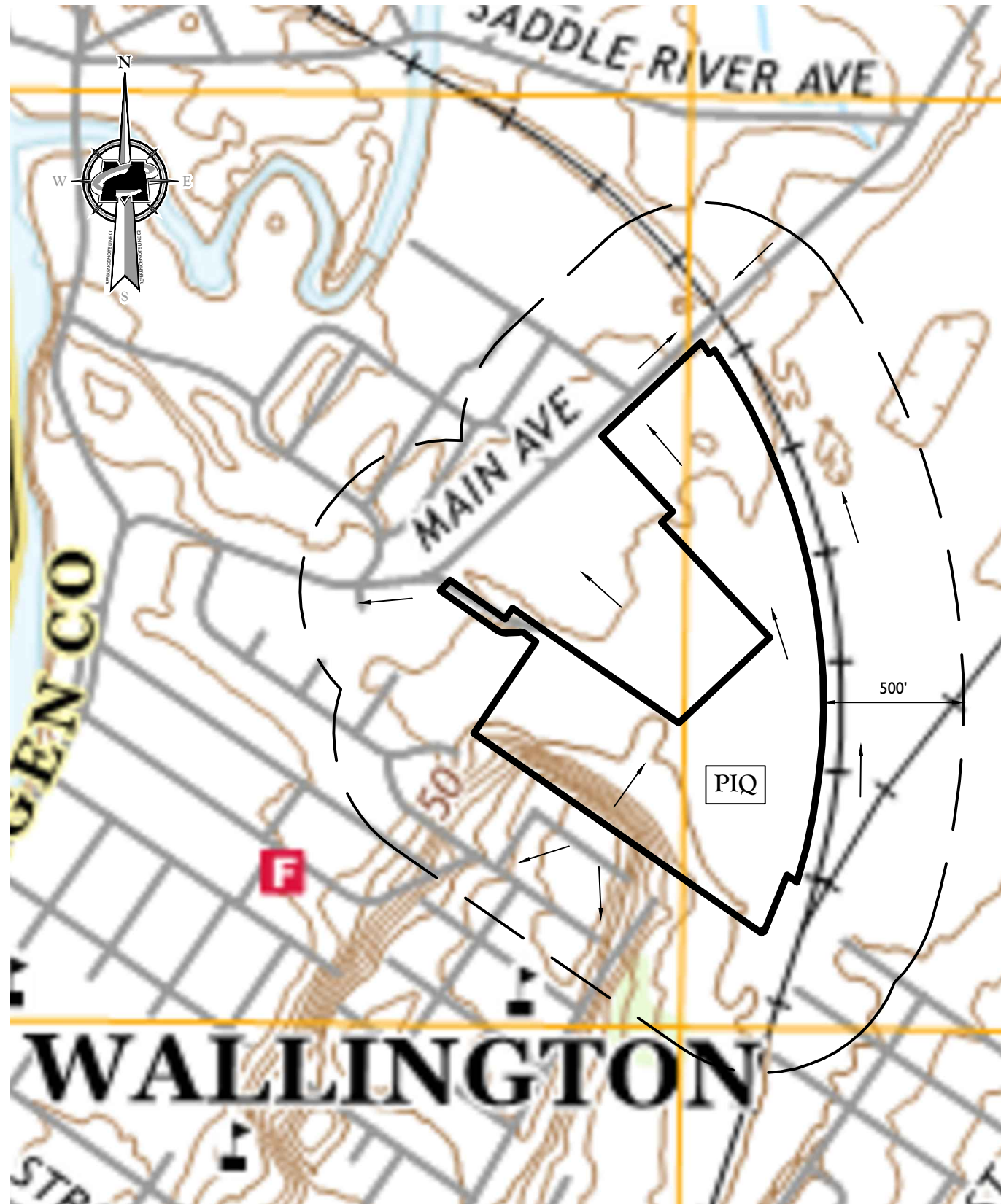

USGS MAP

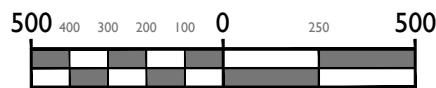

SCALE : 1" = 500'

NOTES:

1. THE SITE WAS VISITED ON FEBRUARY 25, 2020 WHERE THE FLOWS NOTED WERE OBSERVED.
2. THE AERIAL MAP SHOWN IS COURTESY OF GOOGLE EARTH; IMAGERY DATE: 10/11/2014
3. THE USGS MAP SHOWN IS COURTESY OF US DEPARTMENT OF THE INTERIOR; WEEHAWKEN, NJ-NY (2016)
4. SITE REDEVELOPMENT WILL RESULT IN A REDUCTION OF IMPERVIOUS AREA OF 1.34 ACRES.

MASER CONSULTING P.A.
 Customer Loyalty through Client Satisfaction
 www.maserconsulting.com

Office Locations:
 ■ NEW JERSEY ■ MARYLAND
 ■ NEW YORK ■ GEORGIA
 ■ PENNSYLVANIA ■ TEXAS
 ■ FLORIDA ■ TENNESSEE
 ■ NORTH CAROLINA ■ COLORADO
 ■ NEW MEXICO ■ VIRGINIA

State of N.J. C.O.A.: 0008671/0008821
 State of N.J. C.O.A.: 24GA27986500

Copyright © 2020, Maser Consulting P.A. All Rights Reserved. This drawing and all the information contained herein is submitted for use only by the party for whom the service was contracted or its agents. This drawing may not be copied, reused, disclosed, distributed or relied upon for any other purpose without the express written consent of Maser Consulting P.A.

811 PROTECT YOURSELF
 ALL STATES REQUIRE NOTIFICATION OF EXCAVATORS, DESIGNERS, OR ANY PERSON PREPARING TO DISTURB THE EARTH'S SURFACE ANYWHERE IN ANY STATE

Know what's below.
 Call before you dig.
 FOR STATE SPECIFIC DIRECT PHONE NUMBERS VISIT: WWW.CALL811.COM

REV	DATE	DESCRIPTION

JESSE B. COKELEY
 NEW JERSEY PROFESSIONAL ENGINEER - LICENSE NUMBER 54006

AERIAL EXHIBIT
 FOR
UMDASCH REAL ESTATE USA, LTD.
 BLOCK 70.01
 LOTS 1.01, 1.02,
 4.02, 4.03, & 4.04
 WALLINGTON BOROUGH
 BERGEN COUNTY
 NEW JERSEY

MONTVALE OFFICE
 50 Chestnut Ridge Road
 Suite 101
 Montvale, NJ 07645
 Phone: 845.352.0411
 Fax: 845.352.2611

SCALE AS SHOWN	DATE	DRAWN BY	CHECKED BY
16002631A	2/25/2020	SF	JBC
PROJECT NUMBER:	DRAWING NAME:		
16002631A	C-CVER		

SHEET TITLE:
500' DRAINAGE MAP

SHEET NUMBER:
 1 of 1